

START HERE - it's easy - follow these instructions

assembly instructions

Components: 1 FRONT PANEL (with DOOR), 3 SIDE PANELS, 4 CONNECTOR STRIPS, 2 SHELVES, 1 TOP, 1 LID, 1 PULL-OUT-PANEL, 1 PUSH-PULL-TOOL

NOTE: Your Earthmaker can be carried to its final site after assembly.

1 Stand the **FRONT PANEL** on a flat, level surface (*NB: see User Guide - Site Selection*). Stand a **SIDE PANEL** at right-angles to the front panel.

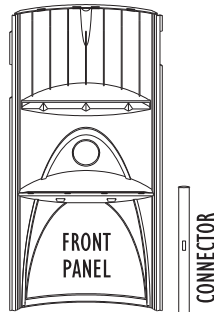

2 Pull the corner tabs together so they overlap. Slide the **CONNECTOR STRIP** between the overlapping tabs - pointed end down. Use the handle at the bottom of the connector to guide the tip.

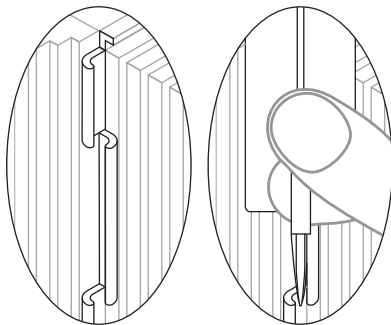

PULL CORNER TABS TOGETHER SO THEY OVERLAP

SLIDE CONNECTOR BETWEEN OVERLAPPING TABS

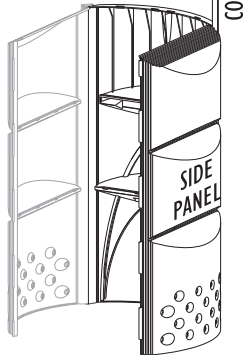
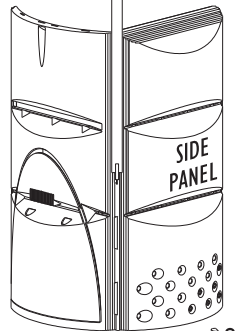

3 Stand another **SIDE PANEL** at right-angles to the other side of the front panel. Repeat step 2.

4 Fit a **SHELF** to the front and side panels at the lower position. *NB: Ensure the shelf lugs are aligned with the slots in the front and side panels.* Working across the back of the shelf - start here - and then down the sides of the shelf gradually push the lugs into slots until you hear the 'click' that tells you it is fixed in place.
HINT 1: Lubricate the lugs and slots to assist assembly.
HINT 2: Use the heel of your hand to push the lugs into place.

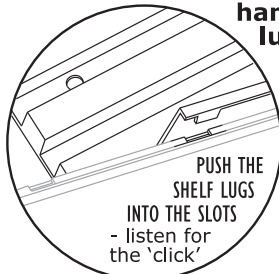
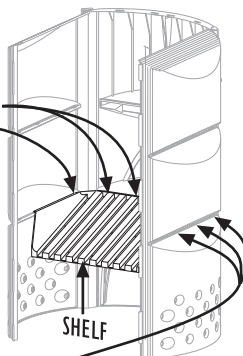

NB: MAKE SURE THE LUGS ARE IN PLACE - check from the outside

PUSH THE SHELF LUGS INTO THE SLOTS - listen for the 'click'

5 After the lower shelf is secure place the **BACK PANEL** between the two side panels - pull the tabs together and slide the connector strips between them as in step 2.

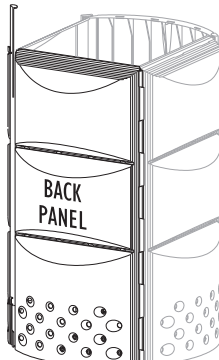

6 Fit the other **SHELF** to the **back panel** and the two side panels - pushing the lugs into the slots.

NOTE: This upper shelf slopes down from the back panel towards the front, while the lower shelf slopes down from the front panel towards the back.

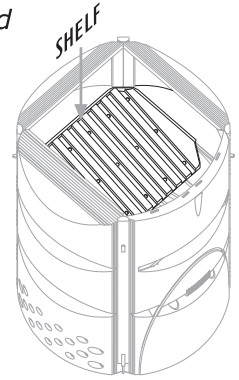

7 Fit the **LID** to the **TOP** in the fully open position. Align the lug on the spindle with the notch in the hole. Holding the lid at a **45° angle**, push the spindle firmly into place then rotate the lid to the closed position. Check from underneath to ensure the spindle is fully in place.

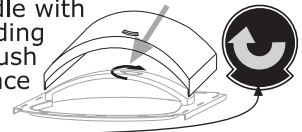

8 Fit the **TOP PANEL**. Starting with the back and sides, **snap the slots over the tabs**. Support the side panels from the inside while pushing the top panel down to **make a definite click**. Snap the slots at the front over the tabs on the Front Panel while pushing the front panel out from the inside.

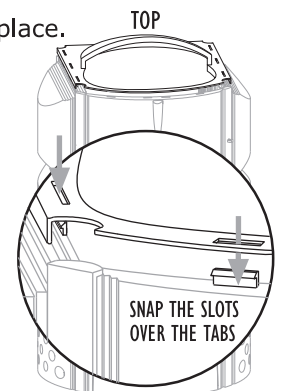

9 Place the **DOOR** in the front panel. Insert the **PULL-OUT PANEL** into the slot above the door.

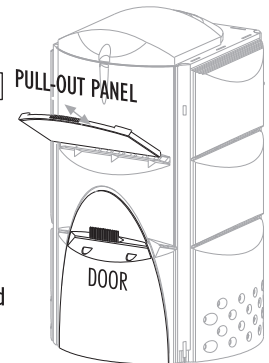

10 Position the Earthmaker, so that it is:

- conveniently positioned in relation to your kitchen
- on a flat, level, well drained surface (eg: paving slabs)
- shaded from hot sun
- suitably positioned for extracting mature compost.

CHECK that the top is properly in place after moving.

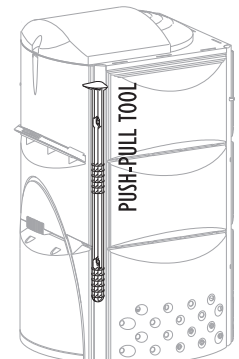

11 Hang the **PUSH-PULL-TOOL** on a hook at the top of one of the connector strips.

Your Earthmaker is now ready for use - read the **User Guide**.